



DELIVERING RESULTS,
RELIABILITY & CONSTANCY



MAPSONS
INDIA PVT. LTD

www.mapsonindia.com

ABOUT US

Mapsons India Private Limited is an ISO 9001:2015 TUV SUD Certified Company which Located in Pune India , is a professional manufacturer of stainless steel Pipe Fittings & Tank fittings. Established in 1993, Mapsons has earned wide acclaim for its high quality products, advanced manufacturing processes and state-of-the-art innovations. Mapsons have skillful production people and strong R&D technicians who have accumulated over 30 years experience in manufacturing, developing and designing various Tank and pipe fittings for Dairy & Beverage, Food, Pharma & Chemical Industry At Mapsons, we are committed we providing the highest level of customer service, competitive pricing, timely delivery and a comprehensive, high quality product offering.



QUALITY PROMISE

We Provide technical support, and if quality problem offer return and exchange service.

We are committed to developing and meeting the needs of different markets in domestic also around the world.

We insist the goal **“Make the customers satisfied, let the customer profitable.”**



MANUFACTURING FACILITIES

Being a total solution provider in the field of precision Engineering Components, we have developed the following sections and division in the manufacturing facility so as to provide the best to the customers:

- In House Designing Division.
- Fully Mechanised Press Shop
- Fully Mechanised Fabrication Shop
- Fully Mechanised Tool Room.
- In House Testing Facility.

Apart from the above we have a full technical support and customer service which takes care of all customer needs and requirements.



TANK MANHOLE COVER

NON PRESSURE MANHOLE

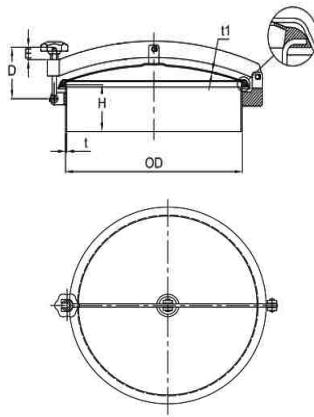

Size	OD mm	t mm	H mm	t1 mm
200	200	2.5	100	2
219	219	2.5	100	2
300	300	2.5	100	2
350	350	2.5	100	2
400	400	3	100	2.5
430	430	3	100	2.5
450	450	3	100	2.5
500	500	3	100	2.5
600	600	4	100	3
400x300	400x300	3	100	2.5

PRESSURE MANHOLE

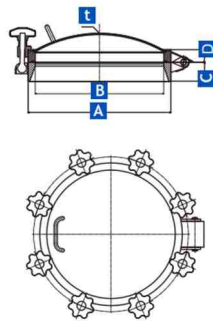

Size	OD mm	t mm	H mm	t1 mm	Handwheel Num	Press (Bar)
350	356	4	100	3	4	1-8
400	406	4	100	3	5	1-8
430	436	4	100	3	6	1-8
450	456	4	100	3	6	1-8
500	506	4	100	3	8	1-8
600	608	4	100	4	10	1-8

FULL VIEW GLASS MANHOLE

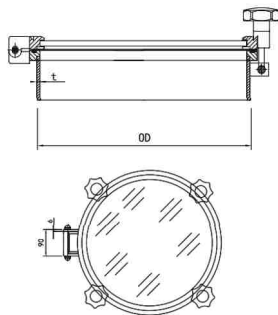

Size	t mm	H mm	t1 mm	Handwheel Num
300	3	100	8	4
350	3	100	8	4
400	3	100	8	5
450	3	100	8	6
350	3	100	10	8
400	4	100	12	10

SWING MANHOLE WITH TWO INTERSECTANT ARMS

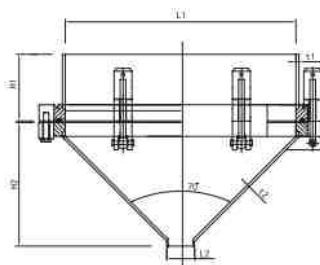

Size	Odmm L1	Odmm L1	t mm	t mm	H mm	t1 mm	Press (Bar)
Dn450	450	50.8	6	4	160	318	1- 4
Dn450	450	102	6	4	160	284	1- 4

WELD FITTINGS

TORISPHERICAL DISHEND / END CAP

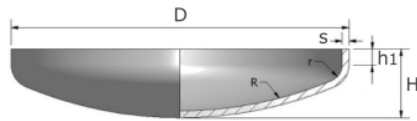

SR No	Size	D	S	H
1	2"	51	1.2-3	25
2	3"	76	1.6-5	30
3	4"	114	2-5	35
"	"	"	"	"
"	"	"	"	"
98	18"	457	3-8	130
99	20"	508	3-8	140
100	24"	610	3-8	145

PIPE FLARING FOR WELDING CONNECTION

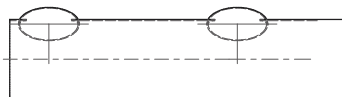

Sr. No.	Welding Connection Size	Pipe Size
1	1"	1" SCH 5, SCH 10
2	2"	1" – 2" SCH 5, SCH 10
3	3"	1" – 3" SCH 5, SCH 10
4	4"	1" – 4" SCH 5, SCH 10
5	5"	1" – 5" SCH 5, SCH 10
6	6"	1" – 6" SCH 5, SCH 10
7	8"	1" – 8" SCH 5, SCH 10
8	10"	1" – 10" SCH 5, SCH 10
9	12"	1" – 12" SCH 5, SCH 10

STANDARD/ NON STANDARD - SHORT TEE

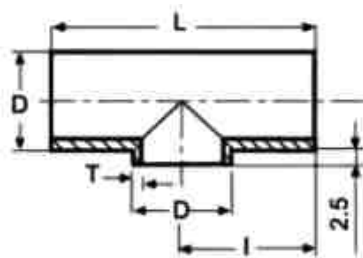

Size	D	T	L	I
DN 10	13	2.5	52	26
DN 15	19	2.5	70	35
DN 20	23	4.5	80	40
DN 25	29	4.5	100	50
DN 32	35	4.5	110	55
DN 40	41	4.5	120	60
DN 50	53	4.5	140	70
DN 65	70	5.0	160	80
DN 80	85	5.0	180	90
DN 100	104	5.0	200	100
DN 125	129	5.0	375	187.5
DN 150	154	5.0	450	225
DN 200	204	5.0	600	300

PIPE FITTINGS

BARREL NIPPLE THREAD STANDARD NPT, BSPT, BSP

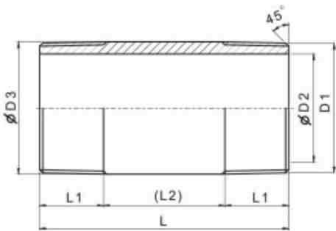

SIZE	D2	L
1/8"	6.0	40
1/4"	9.0	40
3/8"	12.0	40
1/2"	16.0	60
3/4"	21.0	60
1"	27.0	60
1 1/4"	35.0	80
1 1/2"	40.0	80
2"	53.0	100
2 2/2"	66.0	100
3"	79.0	120
4"	10.30	120

PIPE CLAMP

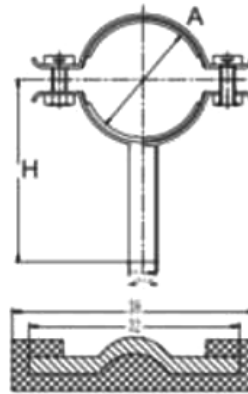

SIZE	A	H
1/2	12.7	90
3/4	19.1	90
1"	25.4	90
1 1/2"	38.1	90
2"	50.8	90
2 1/2	63.5	90
3"	76.2	90
4"	101.6	90
5"	129	125
6"	154	135
8"	204	145
10"	254	174
12"	304	200

TRI-CLAMP FERRULE 304/316L/ TI Gr2



Size	Size
1/8"	1 1/4"
1/4"	1 1/2"
3/8"	2"
1/2"	2 2/2"
3/4"	3"
1"	4"

SMS BLANK LINER, 316L

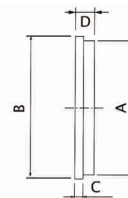

Size	A	B	C	D
25	31.2	35.5	3.5	7
38	47	55.5	5.0	8
51	59.5	65.5	5.0	8
63.5	73	80	5.0	8
76	86	93	5.0	8
101.6	112	118	6.0	10

CLAMP BLANK END CAP, 304 AND 316L

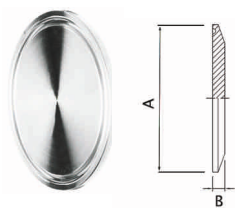

Size	A	B
13	25.4	4.0
19	25.4	4.0
25	50.5	6.35
38	50.5	6.35
51	64	6.35
63.5	77.5	6.35
76	91	6.35
101.6	119	7.90

WELD HOSE NIPPLE, 316L

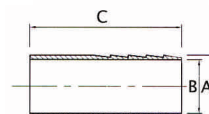
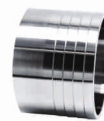

Size	A	B	C
25	25.4	20.6	30.3
38	38.1	33.2	30.3
51	50.8	46	36.5
63.5	63.5	58.7	37.5
76	76.2	71	56.5
101.6	101.6	96	63.5

TANK FITTINGS

SMS NUTS 304/ 316L/ TI Gr2

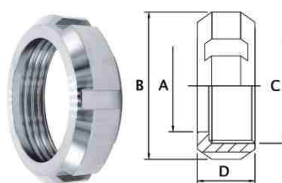

Size	A	B	C	D
25	32	51	RD 40X1/6"	19
38	48	74	RD 60x 1/6"	23
51	60.5	84	RD 70X1/6"	24
63.5	74.0	100	RD 85X1/6"	28
76	87.0	114	RD 98x 1/6"	30
101.6	113.0	138	RD125X1/6"	31

SMS WELDING MALE PART, 304/316L/ TI Gr2

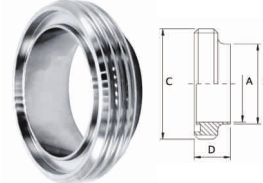

Size	A	B	C	D
25	22.5	25.4	RD 40X1/6"	19
38	35.5	38.1	RD 60x 1/6"	23
51	48.5	50.8	RD 70X1/6"	23
63.5	60.5	63.5	RD 85X1/6"	27
76	72.9	76.1	RD 98x 1/6"	27
101.6	97.6	101.6	RD125X1/4"	30

SMS WELDING LINER 304/316L/ / TI Gr2

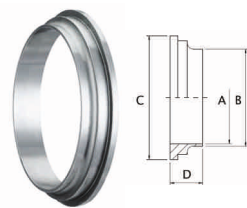

Size	A	B	D
25	22.5	25.4	15.5
38	35.5	38.1	16
51	48.5	50.8	17
63.5	60.5	63.5	17
76	72.9	76.1	19
101	97.6	101.6	19

SEAL FOR SMS UNION

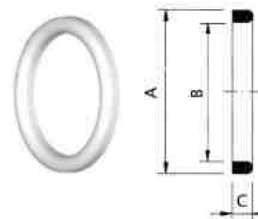

Size	A	B	C
25	40	30	5
32	46	36	5
40	52	42	5
50	64	54	5
65	81	71	5
80	95	85	5
100	114	104	5

CLEANING BALL, 304/ 316L

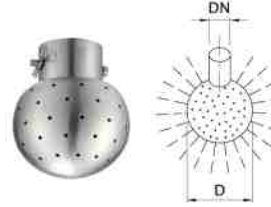

Size	C	D
DN 13 x D 30 mm.	6,000 L/H	1.50 M
DN 19 x D 40 mm.	6,000 L/H	1.50 M.
DN 25 x D 53 mm.	9,000 L/H	1.60 M.
DN 25 x D 65 mm.	9,000 L/H	1.60 M.
DN 38 x D 65 mm.	9,000 L/H	1.60 M.
DN 38 x D 90 mm.	12,900 L/H	2.00 M
DN 51 x D 90 mm.	12,900 L/H	2.00 M.

SIGHT GLASS WITH PROTECTIVE GUARD, 316L,

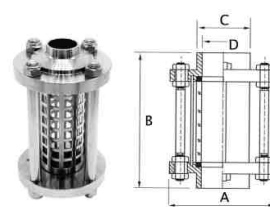

Size	A	B	C	D
25	78.0	140.0	25.4	22.6
38	86.0	140.0	38.1	35.6
51	102.0	142.0	50.8	48.0
63.5	115.0	146.0	63.5	60.3
76	124.0	146.0	76.2	72.9
101.6	154.0	154.0	101.6	97.6

UNION TYPE SIGHT GLASS, 316L



Size	A	B	C	T
63.5	63.5	100.0	32	2.00
76	76.2	114.0	33	2.00

SEAL FOR DIN UNION

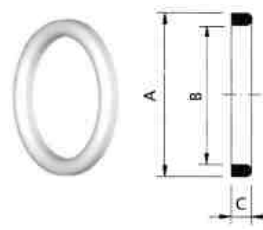

Size	A	B	C
25	40	30	5
32	46	36	5
40	52	42	5
50	64	54	5
65	81	71	5
80	95	85	5
100	114	104	5

WELD FITTINGS

STANDARD/ NON STANDARD TEE

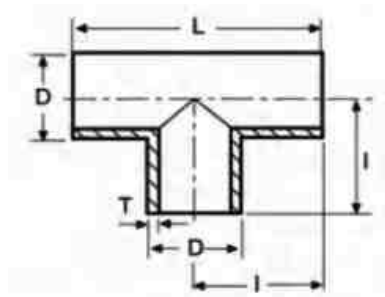

Size	D	T	L	I
DN 10	13	1.5	52	26
DN 15	19	1.5	70	35
DN 20	23	1.5	80	40
DN 25	29	1.5	100	50
DN 32	35	1.5	110	55
DN 40	41	1.5	120	60
DN 50	53	1.5	140	70
DN 65	70	2.0	160	80
DN 80	85	2.0	180	90
DN 100	104	2.0	200	100
DN 125	129	2.0	375	187.5
DN 150	154	2.0	450	225
DN 200	204	2.0	600	300

90 DEG. SHORT ELBOW - 304 & 316L/ TI Gr2

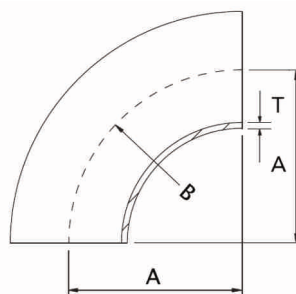

SIZE	A	B	T
13	19.1	19.1	1.50
19	28.5	28.5	1.50
25	38.1	38.1	1.50
38	57.2	57.2	1.50
51	76.2	76.2	1.50
63.5	95.3	95.3	1.50
76	114.3	114.3	1.50
101.6	152.4	152.4	2.10
152.4	228.6	228.6	2.80

90 DEG. LONG ELBOW - 304 & 316L/ TI Gr2

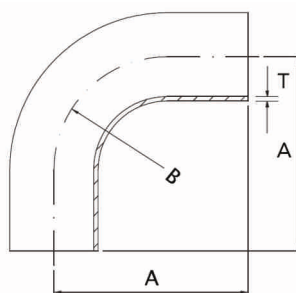

SIZE	A	B	T
25	55.0	32.0	1.20
38	70.0	45.0	1.20
51	82.0	58.0	1.20
63.5	105.0	70.0	1.50
76	110.0	76.0	1.50
101.6	150.0	110.0	2.0

ECCENTRIC CONCENTRIC REDUCER - 304, 316L/ TI Gr2



SIZE	A	B	T
19X13	19.1	12.7	28.0
25X13	25.4	12.7	30.0
25X19	25.4	19.1	30.0
”	”	”	”
101X51	101.6	50.8	95.0
101X63.5	101.6	63.5	78.0
101X76	101.6	76.2	60.0



OTHER SPECIAL COMPONENT

Manufacturer & Supplier of Special Component for Dairy & Beverage, Food & Pharma in India.

Made from Stainless Steel 304/ 316L, Duplex, Titanium & as per customer demand. Each component is tested for its flawless manufacturing standards and dimensional accuracy before it is sent at clients end.

**CABLE TRAY | AIR DISTRIBUTOR | AIR VEND | BARREL NIPPLE | TC FERRULE | DISHENDS
TITANIUM + SS CLADDING TUBE SHEET | TITANIUM PIPE FITTINGS | TOP TANK FLANGE**



CUSTOMIZED MACHINING COMPONENT

As a competent resource for the production and refinement of customer-specific precision parts, Custom Machining has many years of experience both in the processing of standard materials as well as demanding materials, such as tempered steel.

All from a single source.



CUSTOMIZED PRESS COMPONENT



CUSTOMIZED FABRICATION SERVICE

Custom Fabrication Services in Stainless Steel Working with you to identify solutions that perform simply and effectively. Stainless Tank & Mix is able to relate to the specific requirements of your industry and your application so we can work with you to identify solutions that perform simply and effectively.

This can involve creating a custom stainless steel solution that can include the development of a new design that will meet your needs or customising one of our extensive range of stainless steel products to more closely align with your business



DAIRY TANK | BRAVERY TANK | PRESSURE VESSELS | HEAT EXCHANGER | FILTER & HOUSING | SKID





INDUSTRY WE SERVE

- FOOD AND BEVERAGE INDUSTRY
- DAIRY AND ICE CREAM INDUSTRY
- BEER AND WINE INDUSTRY
- PHARMACEUTICAL INDUSTRY
- REFRIGERATION INDUSTRY
- CHEMICAL INDUSTRY



Office : Plot No. J - 288, S Block, Bhosari MIDC,
Pune - 411026. Maharashtra (INDIA)
Tel: +91 20 2712 0006 | +91 9922 3959 44
E-mail : info@mapsonsindia.com

www.mapsonsindia.com